

NOTICE!!

These documents have been scanned!

Do not place un-scanned documents beneath this notice!

Do not remove this notice from this file!

GPO Jacket No. 560-102
Print Order 61540
Rise Business Services, LLC
Job=AZ15 4/26/2019



Box Number= AZ15001



Claim Begin-End: AMC451033-AMC451033

1 Initial Receipt



AZ15001-23

AMC450400-AMC453366

United States Department of the Interior
Bureau of Land Management
 DIV OF LANDS, MINRLS & ENERGY
 ONE N CENTRAL AVE
 PHOENIX, AZ 85004 -4427
 Phone: 602-417-9200

Receipt

No: 4182210

Transaction #: 4296752	
Date of Transaction: 06/05/2018	
CUSTOMER:	
	RETTA ATKINS 9250 E DILLIGAF RD KINGMAN, AZ 86401-8009 US

ENTERED
 JUN 11 2018
 BY: RAM

LINE #	QTY	DESCRIPTION	REMARKS	UNIT PRICE	TOTAL
1	1.00	LOCATABLE MINERALS / MINING CLAIMS-NEW, UNADJUD, ONE OR MORE AUTH NOS / NEW MINING CLAIM PROCESSING FEE CASES: AMC451033/\$20.00		- n/a -	20.00
2	1.00	LOCATABLE MINERALS / MINING CLAIMS-NEW, UNADJUD, ONE OR MORE AUTH NOS / NEW MINING CLAIMS LOCATION FEE CASES: AMC451033/\$37.00		- n/a -	37.00
3	1.00	LOCATABLE MINERALS / MINING CLAIMS-NEW, UNADJUD, ONE OR MORE AUTH NOS / NEW MINING CLAIMS MAINTENANCE FEE CASES: AMC451033/\$155.00		- n/a -	155.00
TOTAL:					\$212.00

PAYMENT INFORMATION			
1	AMOUNT:	212.00	POSTMARKED: N/A
	TYPE:	CHECK	RECEIVED: 06/05/2018
	CHECK NO:	1170	
	NAME:	DBA THE GOLD LADY STORE ATKINS, RETTA 3582 E GORDON DR KINGMAN AZ 86409 US	

REMARKS
ADDL INFO: LOCATION DATE LISTED AS 11 MAY 2018

This receipt was generated by the automated BLM Collections and Billing System and is a paper representation of a portion of the official electronic record contained therein.

NOTICE!!

These documents have been scanned!

Do not place un-scanned documents beneath this notice!

Do not remove this notice from this file!

GPO Jacket No. 560-102
Print Order 61540
Rise Business Services, LLC
Job=AZ15 4/26/2019



Box Number= AZ15001



Claim Begin-End: AMC451033-AMC451033

2 Correspondence



AZ15001-23

AMC450400-AMC453366

**NO
DOCUMENTS
FOUND**

NO DOCUMENTS FOUND
NO DOCUMENTS FOUND

NOTICE!!

These documents have been scanned!

Do not place un-scanned documents beneath this notice!

Do not remove this notice from this file!

GPO Jacket No. 560-102
Print Order 61540
Rise Business Services, LLC
Job=AZ15 4/26/2019



Box Number= AZ15001



Claim Begin-End: AMC451033-AMC451033

3 Transfers



AZ15001-23

AMC450400-AMC453366

**NO
DOCUMENTS
FOUND**

NO DOCUMENTS FOUND
NO DOCUMENTS FOUND

NOTICE!!

These documents have been scanned!

Do not place un-scanned documents beneath this notice!

Do not remove this notice from this file!

GPO Jacket No. 560-102
Print Order 61540
Rise Business Services, LLC
Job=AZ15 4/26/2019



Box Number= AZ15001



Claim Begin-End: AMC451033-AMC451033

4 Annual Filings



AZ15001-23

AMC450400-AMC453366

DEPARTMENT OF THE INTERIOR
BUREAU OF LAND MANAGEMENT
MAINTENANCE FEE WAIVER CERTIFICATION

FORM APPROVED
OMB NO. 1004-0114
Expires: January 31, 2020

SEE INSTRUCTIONS ON PAGE 2

428
428

451033
395597

- This small miner waiver is filed for the assessment year beginning on September 1, 2018 and ending on September 1, 2019
- The undersigned and all related parties owned ten or fewer mining claims, mill, or tunnel sites located and maintained on Federal lands in the United States of America on September 1, 2018.
- The undersigned have performed the assessment work required by law for each mining claim listed prior to filing this waiver and understand that by filing this form, the undersigned must file an affidavit of assessment work with the Bureau of Land Management (BLM) by the December 30th following the filing of this waiver.
- The undersigned understand that if the assessment work obligation has not yet come due under 30 U.S.C. 28 (for those claims in their first assessment year only), a notice of intent to hold reciting this condition must be recorded by the December 30th following the filing of this waiver.
- The undersigned understand that mill and tunnel sites may also be listed on this waiver and be waived from payment of the maintenance fee, and that a notice of intent to hold for these sites is required to be filed with the BLM by the December 30th following the filing of this waiver.
- The undersigned understand and acknowledge that pursuant to 43 U.S.C. 1212 and 18 U.S.C. 1001, the filing or recording of a false, fictitious, or fraudulent document with the BLM may result in a fine of up to \$250,000, a prison term not to exceed five years, or both.
- The mining claims, mill or tunnel sites for which this waiver from payment of the maintenance fees is requested are:

CLAIM OR SITE NAME	BLM RECORDATION SERIAL NUMBER
1. Nut Cracker Amc 395597	Amc 2008077605
2. Money 395598	Amc 2008077607
3. Keeper 1 395599	Amc 2008077608
4. Keeper 2 395600	Amc 2008077606
5. Jasper 395601	Amc 2008077609
6. Nochie B 451033	Amc 2018029707
7.	Amc
8.	
9.	
10.	

The owner(s) (claimants) of the above mining claims and sites are:

RET Betta Atkins
(Owner's Name - Please Print)
9250 E Dilligoff R
(Owner's Mailing Address)

Betta Atkins
(Owner's Signature)
Kingman AZ 86401
(City) (State) (Zip Code)

(Owner's Name - Please Print)

(Owner's Mailing Address)

(Owner's Signature)

(City) (State) (Zip Code)

(Owner's Name - Please Print)

(Owner's Mailing Address)

(Owner's Signature)

(City) (State) (Zip Code)

(Owner's Name - Please Print)

(Owner's Mailing Address)

(Owner's Signature)
AC 483
ENTERED SEP 13 2018
(City) (State) (Zip Code)

(Continued on page 2)

4245151

RECEIVED
BLM AZ STATE OFFICE
2018 SEP 23 P 2:45
PHOENIX, ARIZONA

AKW / CB

Date and Time Run:

8/29/2018 1:50:47 PM

Page 1 of 1

DEPARTMENT OF THE INTERIOR
BUREAU OF LAND MANAGEMENT

Mining Claims

**CUSTOMER
INFORMATION**

Admin State: AZ
Geo State: AZ
ATKINS RETTA 2228952
9250 E DILLIGAF RD
KINGMAN AZ 86401-8009

Serial Number	Lead Serial Number	Claim Name
AMC451033	AMC451033	NOCHIE B
AMC395601	AMC395597	JASPER
AMC395600	AMC395597	KEEPER 2
AMC395599	AMC395597	KEEPER 1
AMC395598	AMC395597	MONEY TREE 1
AMC395597	AMC395597	NUT CRACKER 1

NO WARRANTY IS MADE BY BLM
FOR USE OF THE DATA FOR
PURPOSES NOT INTENDED BY BLM

395597

Form 3830-4
(January 2017)

UNITED STATES
DEPARTMENT OF THE INTERIOR
BUREAU OF LAND MANAGEMENT

FORM APPROVED
OMB NO.: 1004-0114
Expires: January 31, 2020

AFFIDAVIT OF ANNUAL ASSESSMENT WORK

451033

WHEN RECORDED, MAIL DOCUMENT TO:

NAME: Retta Atkins

ADDRESS: 9250 E Dilligoff Rd

CITY, STATE, ZIP: Kingman AZ 86409

FOR COUNTY RECORDER'S USE

No. of Claims 6

x \$10/claim

Total due BLM \$ 60.00

TO ALL WHOM IT MAY CONCERN:

1. The undersigned certifies that at least \$100 per claim was expended for development, labor and improvements, or equivalent value added, as the annual assessment work for the assessment year ending September 1, 2018 for the following contiguous unpatented mining claim(s), located in the County of Mohave, in the State of AZ.

BLM Serial No.	Name of Claim	Tp	Rg	Sec	Mer	County Recordation Book and Page No.	Co. Recording Date
<u>A/MC</u> 395597	<u>Nut Cracker</u>	<u>21N</u>	<u>15W</u>	<u>19</u>		<u>2008077605</u>	
395598	<u>Money</u>	<u>21N</u>	<u>15W</u>	<u>20</u>		<u>2008077607</u>	
395599	<u>Keeper 1</u>	<u>21N</u>	<u>15W</u>	<u>20</u>		<u>2008077608</u>	
395600	<u>Keeper 2</u>	<u>21N</u>	<u>15W</u>	<u>20</u>		<u>2008077606</u>	
395601	<u>Jasper</u>	<u>21N</u>	<u>15W</u>	<u>20</u>		<u>2008077609</u>	
451033	<u>Nochie B</u>	<u>21N</u>	<u>15W</u>	<u>20</u>		<u>2018077609</u>	

RECEIVED
BLM AZ STATE OFFICE
AUG 23 P 2:45
PHOENIX, ARIZONA

4245157

ENTERED
AUG 29 2018
BY: Ram

markings sufficient to appropriately designate the corner of the claim to which it pertains and the name of the claim(s).

I hereby certify under penalty of perjury under the laws of the State of ARIZONA that the foregoing statements are true and correct.

[Signature] Date: 8-18-18
(Signature of person responsible for above statement)

Title 18 U.S.C. 1001 and 43 U.S.C. 1212 make it a crime for any person knowingly and willfully to make to any department or agency of the United States any false, fictitious or fraudulent statements or representations as to any matter within its jurisdiction.

Notary Block

SUBSCRIBED AND SWORN TO before me, this 18 day of August 20 18

By: [Signature] Alexander Blanco
(Signature of Affiant)

Title: Notary Public

My Commission Expires: 11-24-2021

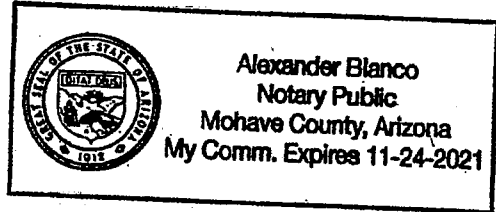

INSTRUCTIONS

1. This is an optional form that may be used to satisfy the requirements for the Bureau of Land Management (BLM) under the provisions of 43 U.S.C. §1744 and 30 U.S.C. §28-28d and the regulations thereunder (43 CFR part 3835). Since local and State laws may vary, you should contact your local and State agencies where the claims are located to ensure all applicable laws and requirements are satisfied.
2. The claimant(s) must fill in the date in paragraph 1 for the applicable assessment year and the county and state where the claims are located.
3. All claim names, BLM serial numbers, legal descriptions, and original county recording information must be listed for the claims pertaining to this assessment notice.
4. The claimant(s) must complete paragraph 2 listing all labor or improvements which was performed on or did benefit the subject mining claims. The value and date of the labor or improvements must also be listed. The total amount of labor or improvements can be listed, but the total expenditure must equal at least \$100 for each claim.
5. The names and current mailing addresses of the person(s) performing the labor shall be listed in paragraph 3.
6. The name and current mailing address of each owner (claimant) of the claims shall be listed in paragraph 4. The mailing address shall be the owner's address and not the address of an agent or anyone representing the claimant. Be sure to note if there has been a change of address.
7. Paragraph 5 shall be completed to show the date it was verified that all monuments required by law were properly erected, all notices were posted, and that corners were appropriately designated for all claims listed.
8. An exact legible reproduction or duplicate (other than microfilm or other electronic media) of this affidavit or another type of affidavit of assessment work that you file or will file in the county where each claim is located, must be filed with the BLM on or before December 30 of the calendar year in which the assessment year ends. For mill or tunnel sites, a separate notice of intent to hold must be filed with the BLM on or before December 30. Requirements for filing a notice of intent to hold can be found at 43 CFR 3835.33.
9. A processing fee of \$10 for each claim listed must be remitted to the BLM along with this or any other affidavit of assessment work.

RECEIVED
STATE OFFICE
PHOENIX, ARIZONA
AUG 23 P 2:45

2. Type of labor and improvements (specify what was done and give the total value for that labor and improvement to show at least \$100 for each claim). If a geological, geochemical, or geophysical survey was performed, as per 30 U.S.C. 28-1, reference the title of the report of survey, give cost and date of the survey and report, and indicate it was filed with the County Recorder:

Description of Work Performed	Value of Work Performed	Date Work Was Performed
Dug test holes		April - 2018
Filed test notes.		April - 2018
Road work	\$400.00	Feb - 12 2017
Assays -	Total work	June 2018
Testing of material	\$900.00	Oct. 2018

3. Name and mailing address of each person who performed the labor and improvements:

Name (please print)

Current Mailing Address (please print)

Retha Atkins
Darren VanHouten

9250 E Dilligal Rd Kingman AZ
9250 E Dilligal Rd Kingman 86401

4. Name and mailing address of each person who holds and claims the subject mining claim(s) for the valuable minerals contained therein. Be sure to indicate if there is a change of address:

Name (please print)

Current Mailing Address (please print)

Retha Atkins

9250 E Dilligal Rd
Kingman AZ 86401

RECEIVED
 BLM AZ STATE OFFICE
 2018 AUG 23 P 2:45
 PHOENIX, ARIZONA

5. The undersigned testifies that on the date of February, 2017, all monuments required by law were erected upon the subject claim(s), and all notices required by law were posted on the subject claim(s) or copies thereof were in place, and at said date, each corner monument bore or contained

Retta Atkins
9250 E Pillbox Rd
Kingman, AZ 86401

RECEIVED
BLM AZ STATE OFFICE
2010 AUG 23 P 2:45
PHOENIX, ARIZONA

BLM
AZ State Office
One North Central Ave
Suite 800
Phoenix AZ 85004-4427

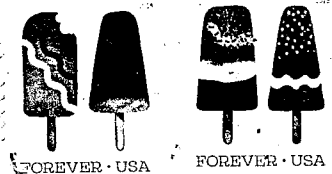

850044427 0041

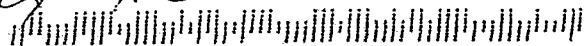

United States Department of the Interior
Bureau of Land Management
 DIV OF LANDS, MINRLS & ENERGY
 ONE N CENTRAL AVE
 PHOENIX, AZ 85004 -4427
 Phone: 602-417-9200

Receipt

No: 4245151

Transaction #: 4360601	
Date of Transaction: 08/27/2018	
CUSTOMER:	
RETTA ATKINS 9250 E DILLIGAF RD KINGMAN, AZ 86401-8009 US	

LINE #	QTY	DESCRIPTION	REMARKS	UNIT PRICE	TOTAL
1	1.00	LOCATABLE MINERALS / MINING CLAIMS- NOT NEW-UNADJUD, ONE AUTH NO. ONLY / MINING CLAIM MONEY RECEIVED CASES: AMC395597/\$60.00	POL 2018/6 WAV	- n/a -	60.00
TOTAL:					\$60.00

PAYMENT INFORMATION			
1	AMOUNT:	60.00	POSTMARKED: N/A
	TYPE:	CHECK	RECEIVED: 08/23/2018
	CHECK NO:	1178	
	NAME:	ATKINS, RETTA 9250 E DILLIGAF RD KINGMAN AZ 86401-8009 US	

REMARKS

This receipt was generated by the automated BLM Collections and Billing System and is a paper representation of a portion of the official electronic record contained therein.

NOTICE!!

These documents have been scanned!

Do not place un-scanned documents beneath this notice!

Do not remove this notice from this file!

GPO Jacket No. 560-102
Print Order 61540
Rise Business Services, LLC
Job=AZ15 4/26/2019



Box Number= AZ15001



Claim Begin-End: AMC451033-AMC451033

5 Miscellaneous



AZ15001-23

AMC450400-AMC453366

**NO
DOCUMENTS
FOUND**

NO DOCUMENTS FOUND
NO DOCUMENTS FOUND

NOTICE!!

These documents have been scanned!

Do not place un-scanned documents beneath this notice!

Do not remove this notice from this file!

GPO Jacket No. 560-102
Print Order 61540
Rise Business Services, LLC
Job=AZ15 4/26/2019



Box Number= AZ15001



Claim Begin-End: AMC451033-AMC451033

6 Location Notices-Amendments and Supporting Documents



AZ15001-23 AMC450400-AMC453366

MINING CLAIM STATUS REPORT

Data Entered: 6/11/18 RAM

MTP Checked By: 6/11/18 RAM
GEO Checked By: 6/11/18 RAM

LEAD SERIAL NUMBER: AMC 45/033 thru AMC _____

NUMBER OF CLAIMS & TYPE:

1 LODE
____ PLACER
____ ASSOCIATION PLACER
____ MILL SITE
____ TUNNEL SITE

CHARGES:

Processing Fee @ \$20 = \$ 20
Location Fee @ \$37 = \$ 37
Maintenance Fee @ \$155 = \$ 155
Add'l Maint Fee for Assoc Placer = \$ _____
SUBTOTAL \$ 212
Other Fees \$ _____
Other Fees \$ _____
TOTAL \$ _____

TOTAL ACREAGE: _____ Per Claim
(Placer Only)

NUMBER OF LOCATORS: 1

DOCUMENTS RECEIVED VIA: Over-the-Counter [] Mail [] TIMELY FILED: Yes [] No []

LEGAL DESCRIPTION: T 21N R 15W SEC 20
T _____ R _____ SEC _____
T _____ R _____ SEC _____
T _____ R _____ SEC _____
T _____ R _____ SEC _____

BLM [] FOREST SERVICE [] SUBJ TO PL 359: Yes [] No []
WILDERNESS AREA [] _____

SPLIT ESTATE: N/A [] SX [] PX [] OTHER [] _____
SRHA [] Was proper Notice filed if located on SHRA Land? Yes [] No []

RECONVEYED MINERALS ON BLM LAND REQUIRE OPENING ORDER FROM 1944 TO 1993:
Open to Entry On _____ N/A []

COMMENTS/STATUS: VOID [] PARTIALLY VOID [] PVT MINERALS [] WITHDRAWN LANDS []
OTHER [] _____

AMC 45/033

[] Claimant acknowledges that portions of the following claim(s) site(s) may be void or voidable.

Printed Name of Claimant _____ Signature of Claimant _____

*****FINAL ADJUDICATION*****

DATE 8/15/18 INITIALS RS

LOCATION NOTICE FOR LODE MINING CLAIM

Amendment BLM Serial # _____

NOTICE IS HEREBY GIVEN that the Nochie B
_____ lode mining claim has been located

by Retha Atkins whose current mailing
address is 9250 E Dilligaf Rd
Kingman Az 86401

RECEIVED
BLM ARIZONA OFFICE
2018 JUN -4 P 2:51
PHOENIX, ARIZONA
BLM
Date
Stamp

The general course of this claim is SW29E to the N. and it is situated in Mohave
County, Arizona. This claim is 1490' feet in length and 590' feet in width.

20 Total Claim Acreage. This claim runs from the location monument on which this location notice
is posted on the centerline of the claim approximately 745 feet in a NE direction to the NORTH
end line and 745 feet in a SW direction to the SOUTH end line. This claim is marked by six
monuments, one at each corner and one at the center of each end line of the claim.

The location monument on which this notice is posted is situated within Section 20, Township 21
N, Range 15 W, Gila Salt River Base and Meridian, Arizona and this claim encompasses portions
of the following quarter section(s), section(s), Township(s) and Range(s) _____

Gila Salt River Base and Meridian, Arizona.

The locality of this claim with reference to some natural object or permanent monument and additional information
(if any) concerning its locality are as follows: 511' 18' 01" E a distance of 1545
50 ft from the west 1/4 corner of Section 20, T21N, R15W, Being a
used brass cap on standard pipe The above information is shown on the attached map.

DATED AND POSTED on the ground this 11 day of May, 2018

LOCATOR(s) AGENT

Print Name(s) Retha Atkins

Signature(s) Retha Atkins

Form MCF100
Revised July 2014

This form is available from the Arizona Geological Survey and may be reproduced.

AMC0451033

MINING CLAIM MAP

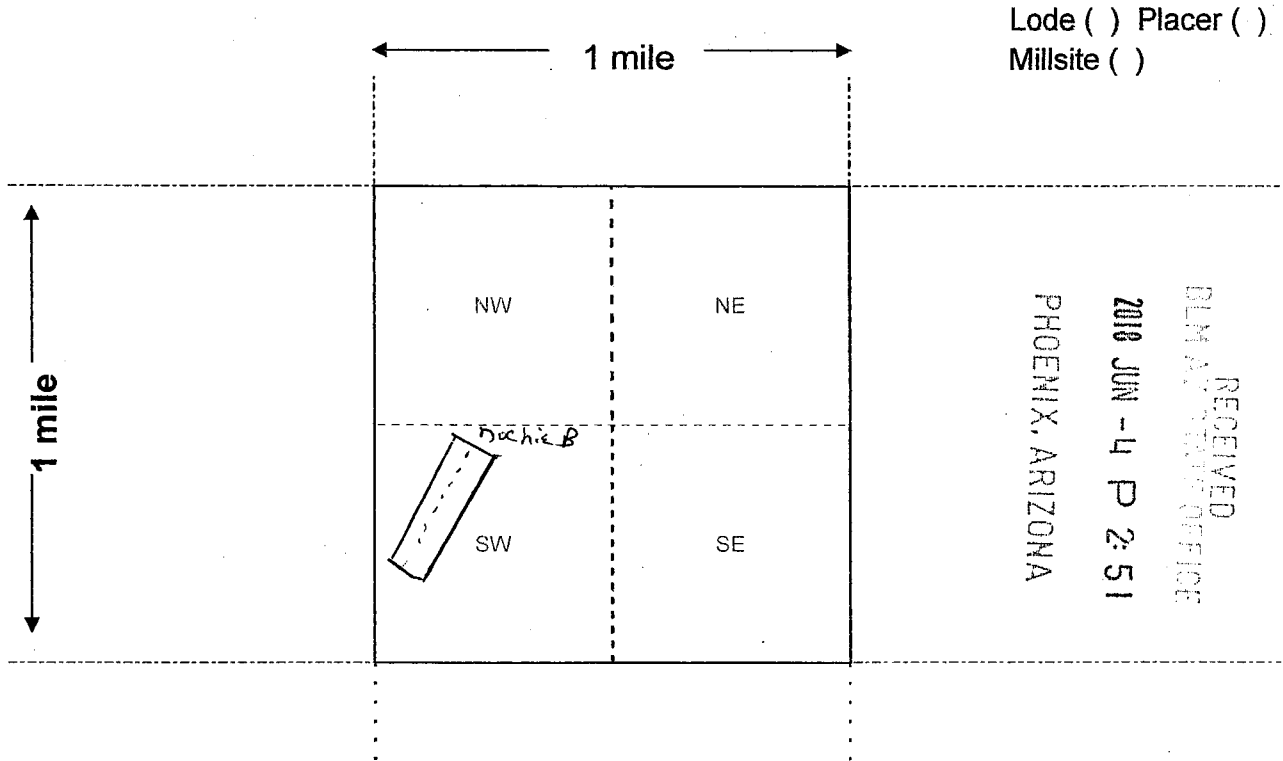

Scale: 1" = 2000 feet



1. The above map depicts the Nochie B mining claim, which is located in Section (s) 20, Township 21 N, Range 15 W, Gila and Salt River Base and Meridian, _____ County, Arizona. Total claim acreage is 20
2. The type of corner and location monuments used are as follows: 2x2 wooden Post w/corner marker
3. The bearings and distances in degrees and feet between claim corners and to a public land survey monument are as depicted on the map.
4. If the claim is a placer or millsite claim with exterior limits conforming to legal subdivisions of the public survey, provide a legal description of the claim _____

AMC451033

Form MCF100a
Revised July 2014

This form is available from the Arizona Geology Survey and may be reproduced.

Input Parameters for Geographic Report with Land

System Id = CR

Admin State = AZ

Geo State =

Casetype Begins With

Case Disp Txt = AUTHORIZED, CANCELLED, EXPIRED, PENDING, REJECTED, VOID, WITHDRAWN

Mer Twp Rng =

Section =

Mtrs = 14 0210N 0150W 020, 14 0210N 0150W 999

Commodity =

Commodity Txt =

Pending Org =

Pend Org Decode =

Total Rows Returned: 8

RUN TIME: 12:50 PM

UNITED STATES DEPARTMENT OF INTERIOR
BUREAU OF LAND MANAGEMENT
GEOGRAPHIC REPORT WITH LAND
Sorted by Serial Number

RUN DATE: 06/11/2018
Page 2 of 2

Adm State: AZ

Serial Number: AZA 034437
Total Case Acres: 0.727

<u>Casetype</u>	<u>Case Disp</u>	14	0210N	0150W	<u>Sect</u>	<u>Sur Typ</u>	<u>Sur Num</u>	<u>Suff</u>	<u>Subdivision</u>	<u>Act Pend</u>
281001	AUTHORIZED				020	MNR			SWSENW,NWNESW;	

Serial Number: AZA 034438
Total Case Acres: 0.242

<u>Casetype</u>	<u>Case Disp</u>	14	0210N	0150W	<u>Sect</u>	<u>Sur Typ</u>	<u>Sur Num</u>	<u>Suff</u>	<u>Subdivision</u>	<u>Act Pend</u>
286203	AUTHORIZED				020	MNR			SWSENW,NWNESW;	

RUN TIME: 12:50 PM

UNITED STATES DEPARTMENT OF INTERIOR
BUREAU OF LAND MANAGEMENT
GEOGRAPHIC REPORT WITH LAND
Sorted by Serial Number

RUN DATE: 06/11/2018
Page 1 of 2

Serial Number: AZA 018606FD
Total Case Acres: 65,317.910

<u>Casetype</u>	<u>Case Disp</u>	14	0210N	0150W	<u>Sect</u>	<u>Sur Typ</u>	<u>Sur Num</u>	<u>Suff</u>	<u>Subdivision</u>	<u>Act Pend</u>
221006	AUTHORIZED				020	ALIQ			SWNE;	

Serial Number: AZA 022792AP
Total Case Acres: 19,435.600

<u>Casetype</u>	<u>Case Disp</u>	14	0210N	0150W	<u>Sect</u>	<u>Sur Typ</u>	<u>Sur Num</u>	<u>Suff</u>	<u>Subdivision</u>	<u>Act Pend</u>
220100	AUTHORIZED				020	ALIQ FF		2	N2NE,SENE,W2,SE; EXCEPT I-40;	

Serial Number: AZA 024993
Total Case Acres: 137.430

<u>Casetype</u>	<u>Case Disp</u>	14	0210N	0150W	<u>Sect</u>	<u>Sur Typ</u>	<u>Sur Num</u>	<u>Suff</u>	<u>Subdivision</u>	<u>Act Pend</u>
288101	AUTHORIZED				020	ALIQ			N2NW;	

Serial Number: AZA 029674
Total Case Acres: 3.950

<u>Casetype</u>	<u>Case Disp</u>	14	0210N	0150W	<u>Sect</u>	<u>Sur Typ</u>	<u>Sur Num</u>	<u>Suff</u>	<u>Subdivision</u>	<u>Act Pend</u>
281001	AUTHORIZED				020	MNR		1	S2NESE;	

Serial Number: AZA 030504
Total Case Acres: 2.060

<u>Casetype</u>	<u>Case Disp</u>	14	0210N	0150W	<u>Sect</u>	<u>Sur Typ</u>	<u>Sur Num</u>	<u>Suff</u>	<u>Subdivision</u>	<u>Act Pend</u>
281001	AUTHORIZED				020	MNR		1	N2NWNW;	

RETTA ATKINS
9250 E DILLIGARD RD
KINGMAN AZ 86401

LAS VEGAS NV 890

30 MAY 2018 PM 4 L



RECEIVED
BLM AZ STATE OFFICE

2018 JUN -4 P 2:51

PHOENIX, ARIZONA

BUREAU OF LAND MANG
1 NORTH CENTRAL AVE SUITE 800
PHOENIX AZ 85000

05004-441499



Arizona State Office
Bureau of Land Management
1 N. Central Ave. Ste. 800
Phoenix, AZ 85004

Retta Attins
9250 E. Dilligaf Rd.
Kingman, AZ 86401

May 22, 2018

Retta:

Your mining claim is being returned to you unprocessed for the following reason:

Incomplete

The claim is not dated and therefore cannot be processed.

Please also include a zip code with your address on the mining claim location.

If you have any questions, please call our office at: 602.417.9200

Thank you,

Accts/BLM

RECEIVED
BLM STATE OFFICE
2018 JUN -4 P 2:51
PHOENIX, ARIZONA

AMC451033